



# SAFFROKOL™

## SAFFROGEL EP- 2K

### Technical Data Sheet



High Bond Strength



Stain Resistance Joints



Chemical Resistance



Temp Resistance



Suitable for various applications



Easy to use

## PRODUCT DESCRIPTION

Saffrogel EP-2K Epoxy Tile Grout component comes with two parts: Part A (Resin Gel) and Part B (Hardener Gel). Each bucket contains five sets, with each set including 700 grams of resin gel and 300 grams of hardener gel.

## FEATURES AND BENEFITS

- Easy mixing and quick setup
- Simple to apply
- Strong, durable, and long-lasting
- Resistant to chemicals, stains, temperature and water
- Low maintenance and easy to clean
- Consistent color for a flawless finish
- Suitable for various applications

## APPLICATION AREAS

- General floor and wall tiling
- Bathrooms and showers
- Floors with underfloor heating
- Kitchen countertops
- Terraces and balconies
- Dairy and food processing plants

## TECHNICAL DETAILS

Conforms To IS 17190:2020 RG2i; EN 13888 RG; ISO 13007-4(C) EN12004 R2T

## PHYSICAL PROPERTIES @27±1°C

Parameter	Results
Appearance	Part A (Resin) : Part B (Hardener)
Mixing Ratio (Part A Part B)	7:3
Mixed Material Consistency	Smooth Creamy Paste
Mixed Density	1700±50 Kg/mm <sup>3</sup>
Pot Life 27±2°C	60 minutes
Workability 27±2°C	45 minutes
Foot Traffic 27±2°C	24 Hours
Initial Setting time 27±2°C	≥3 Hours
Joint Width	2-12mm
Sag Resistant	Non-sag
Total VOC Content {EPA 24 Method}	<8gm/Kg
Application Temperature	10°C to 35 °C
Temperature of Use	20°C to 100 °C

# PERFORMANCE PROPERTIES

## ISO 13077 / EN 1388

Parameter	Requirements	Results	Test Methods
Abrasion resistance	< 250mm <sup>2</sup>	130 - 170 mm <sup>2</sup>	ISO 13007-4: Clause 4.4, EN 12808 - 2
Flexural strength under freeze and thaw cycles	> 30N/mm <sup>2</sup>	35-40 N/mm <sup>2</sup>	ISO 13007-4: Clause 4.1.5, EN 12808 - 3
Compressive Strength under standard conditions	>45 N/mm <sup>2</sup>	50-55 N/mm <sup>2</sup>	ISO 13007-4: Clause 4.1.4; EN 12808-2
Shrinkage	<1.5 mm/m	0.02-0.04 mm/m	ISO 13007-4: Clause 4.3: EN 12808-5
Water Absorption after 240 Minutes	<0.1 g	0.04-0.06 g	ISO 13007-4: Clause 4.2; EN 12808-5

The grout mortar conforms to ISO 13007-4(G)/ EN 13888 RG/EN 12004 R2T

## COVERAGE CHART

Tile Dimension (mm)			Theoretical Coverage in Kg/m						
			Width of joint (mm)						
Length	Width	Thickness	2	3	4	5	6	8	10
25	25	6	1.536	2.304	3.072	3.840	4.608	6.144	7.680
25	50	6	1.152	1.728	2.304	2.880	3.456	4.608	5.760
50	50	6	0.768	1.152	1.536	1.920	2.304	3.072	3.840
100	100	6	0.384	0.576	0.768	0.936	1.152	1.536	1.920
100	100	10	0.640	0.960	1.280	1.600	1.920	2.560	3.200
300	200	6	0.160	0.240	0.320	0.400	0.480	0.640	0.800
300	300	6	0.128	0.192	0.256	0.320	0.384	0.512	0.640
450	300	6	0.107	0.160	0.213	0.267	0.320	0.427	0.533
600	300	6	0.096	0.144	0.192	0.240	0.288	0.384	0.480
600	600	8	0.085	0.128	0.171	0.213	0.256	0.341	0.427
800	800	8	0.064	0.096	0.128	0.160	0.192	0.256	0.320
1000	1000	10	0.064	0.096	0.128	0.160	0.192	0.256	0.320
1200	600	10	0.080	0.120	0.160	0.200	0.240	0.320	0.400
1200	800	10	0.067	0.100	0.133	0.167	0.200	0.267	0.333
1200	1200	12	0.064	0.096	0.128	0.160	0.192	0.256	0.320
1600	800	12	0.072	0.108	0.144	0.180	0.216	0.288	0.360
1800	1200	12	0.053	0.080	0.107	0.133	0.160	0.213	0.267

# INSTALLATION GUIDE FOR SAFFROKOL TILES ADHESIVE

## 1. Surface Preparation

- **Clean the Tiles:** The tile joints and surrounding areas should be free from dust, dirt, and any old grout.
- **Dry the Joints Completely:** The tile joints should be fully dry before applying the epoxy grout. Any moisture can prevent proper bonding and lead to grout failure.
- **Avoid Humid or Rainy Conditions:** High humidity or rain can interfere with the curing process, affecting the grout's strength and durability. It's best to apply epoxy grout in dry conditions.
- **Protect Adjacent Areas:** Use painter's tape to cover areas not being grouted, as epoxy grout is difficult to remove once it cures.



## 2. Mixing Instructions

- **Combine Components** –Combine Resin Gel and Hardener Gel: Pour the resin paste (Part A) into a clean bucket, then add the hardener (Part B).
- **Mix Thoroughly:** Stir the two components together for 2–3 minutes using a margin trowel or a low-speed mixer until the mixture reaches a uniform color and smooth consistency. Check that there are no unmixed portions at the bottom or sides of the container.

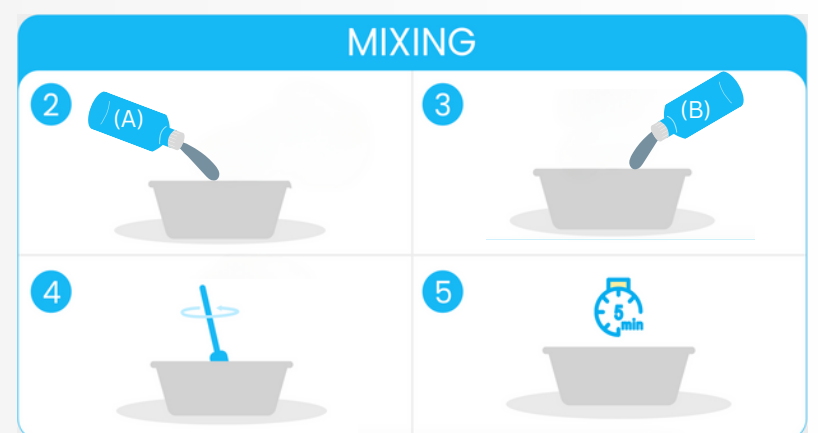

### 3. Apply the grout

- Spread the Grout: Use a grout float to apply the epoxy grout over the tile surface.
- Fill the Joints: Hold the float at a 45-degree angle and press the grout into the joints; and they should be fully packed.
- Work in Small Sections: This prevents the grout from drying before you can clean the surface.
- Remove Excess Grout: Hold the float at a right angle and move it diagonally across the tiles to clear away any extra grout

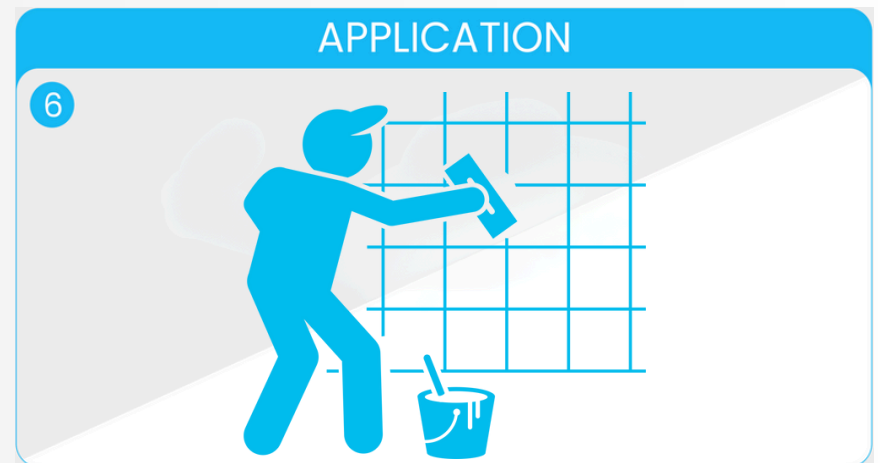

### 4. Clean the tiles

- Allow the Grout to Set: Wait about 10–15 minutes for the grout to firm up slightly (timing may vary based on the product and environmental conditions).
- Wipe Off Grout Haze: Dampen a grout sponge with clean water, squeeze out excess water, and gently wipe the tile surface to remove grout residue.
- Rinse Frequently: Clean the sponge often and change the water as needed to avoid spreading grout haze.

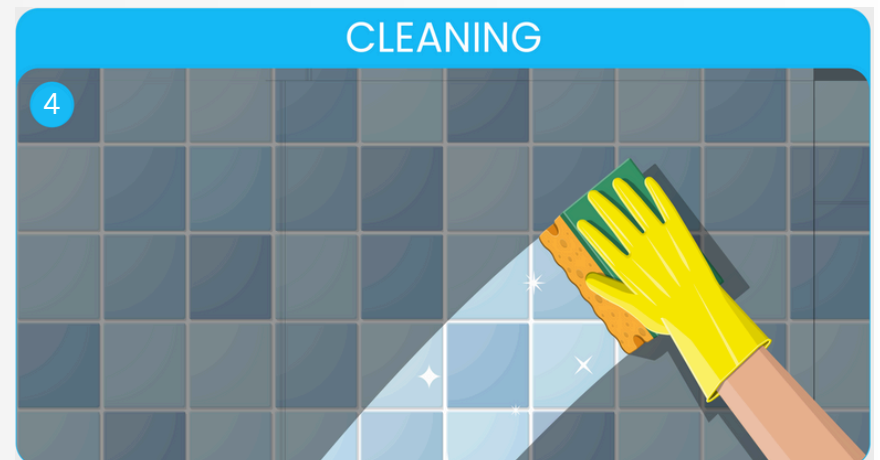

### 5. Curing

- Allow Time to Harden: The grout typically takes 24 to 48 hours to fully cure.
- Keep the Area Dry: Avoid exposing the grout to moisture during the curing period.
- Limit Foot Traffic: Prevent any disturbances or heavy movement over the area until the grout has completely set

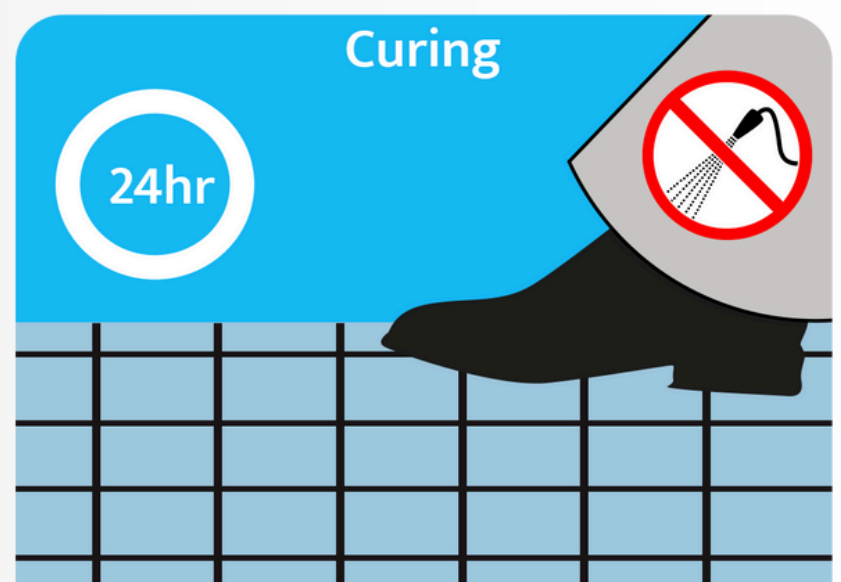

## COLOUR

Choose from a range of 15 colours of Saffrogel EP 2K

For choosing the right colour refer to SAFFROKOL shade card



SCAN FOR  
SHADE CARD

## COVERAGE

For interactive calculator

Scan QR CODE



## LIMITATIONS

- Grout is not a substitute for a waterproofing membrane. If waterproofing is needed, use a suitable product, such as our waterproofing solutions.
- Not recommended for soft, polished marble or delicate glazed tiles.

## SHELF LIFE

Saffrogel EP-2K Epoxy Tile Grout has a shelf life of 12 months when kept in a cool, dry place. However, since factors like temperature, humidity, and site conditions can vary, this timeframe should be considered a general guideline.

## SAFETY PRECAUTIONS

- Keep away from children.
- Wear appropriate protective clothing, gloves, and eye/face protection while handling.
- If grout comes into contact with skin, wash thoroughly with clean water.
- In case of eye contact, rinse immediately with plenty of water and seek medical attention.
- For professional use only.

## KEY NOTES

- The grouted surface reaches its maximum stain resistance 10 days after installation. During this time, protect it from acids and strong cleaners.
- Avoid using grout in areas with heavy machinery, vehicle traffic, or high foot traffic.
- When cleaning, frequently change the water, cloth, or sponge to prevent grout buildup.
- For shower and pool areas, wait at least 7 days after grouting before exposing the surface to water.
- The tiles or stones should be compatible with the grout mixture. Always refer to the application guidelines from the tile/stone manufacturer and conduct a small test patch before grouting the entire area.
- Follow all safety standards and national regulations.
- Use grout only when the temperature is between +5°C and +30°C.

For any further assistance, call us



**BO: Pankaj Petrochem Consultancy LLC**

Licence no. # 2428700, Shams Business Center, Sharjah Media City Freezone, Al Messaned, Sharjah (Dubai) UAE

 Toll Free : 1800-202-732  
Call : +91-8607650126

 [info@saffrokol.com](mailto:info@saffrokol.com)

 [www.saffrokol.com](http://www.saffrokol.com)

**PANKAJ PETROCHEMICAL PVT. LTD.**  
(AN ISO : 9001, 14001 : 2015 CERTIFIED COMPANY)

**Address:** Jind Road, VPO Titoli, RTK, HR,  
124001

